



Vanity Specifications

VAN019

Vanity: 38-1/4" x 23-1/4" x 34"

Materials: birch solids and veneers
Full extension ball bearing drawer slides

Top: 37-1/2" x 23-3/4" x 3cm

Material: 3cm black granite
Bowl hole cut for 17" x 14" bowl
Faucet holes cut for 8" centerset
2cm backsplash included

Mirror: 30" x 37-1/2"

Beveled glass

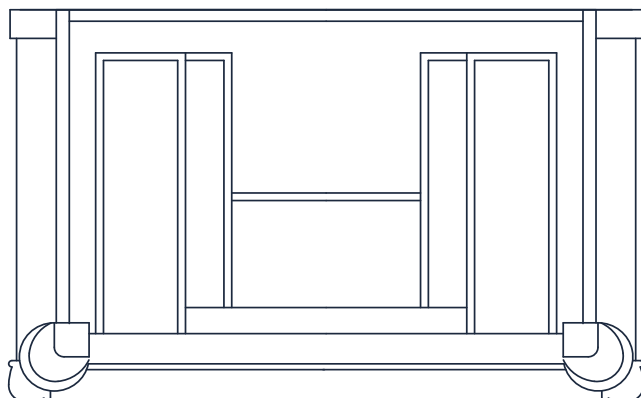
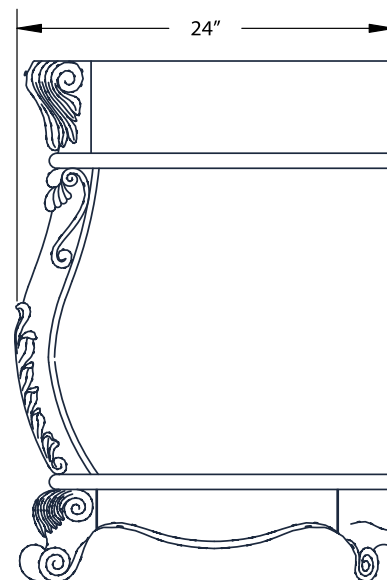
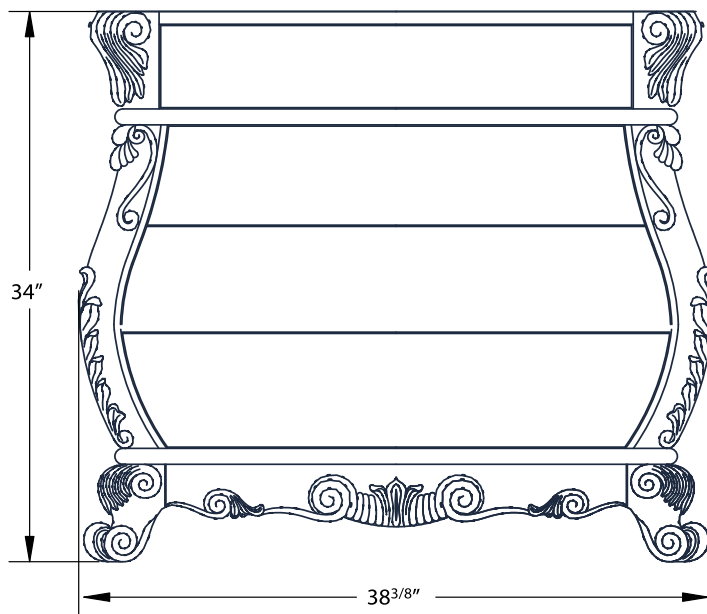

www.lyn-design.com

Manufactured by Hardware Resources • www.hardwareresources.com