

EXPLODED STATUS

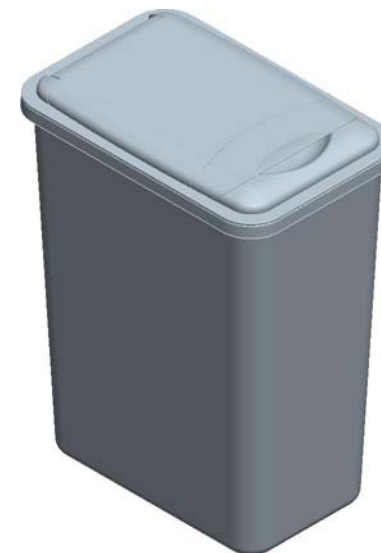

ASSEMBLY STATUS

<b>hardware</b> <b>resources</b>	ITEM#		MATERIAL:	
	TRASH-CAN-35		WEIGHT:	
	FINISH:		9	
	PROJECTION:		DATE:	
<b>PROPRIETARY AND CONFIDENTIAL</b> THE INFORMATION CONTAINED IN THIS DRAWING IS THE SOLE PROPERTY OF HARDWARE RESOURCES INC. ANY REPRODUCTION IN PART OR AS A WHOLE WITHOUT THE WRITTEN PERMISSION OF HARDWARE RESOURCES INC. IS PROHIBITED.	TOLERANCE UNLESS OTHERWISE SPECIFIED: X : MM ±0.20 X.X : MM ±0.10 X.XX : MM ±0.05 ANGULAR: ±0.5° DO NOT SCALE DRAWING	UNIT:	DRAWN BY: <i>alan.liu</i>	DATE:
		SIZE:	CHECKED BY:	DATE:
			APPROVED BY:	DATE:

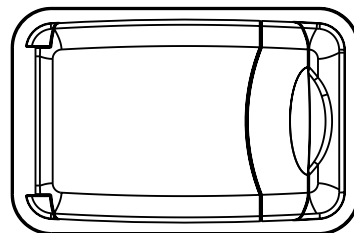
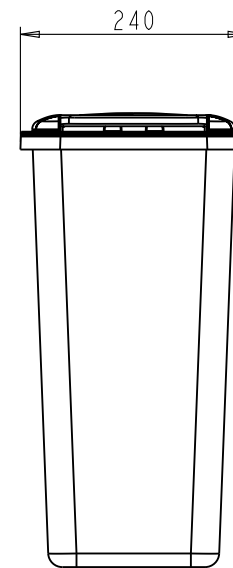
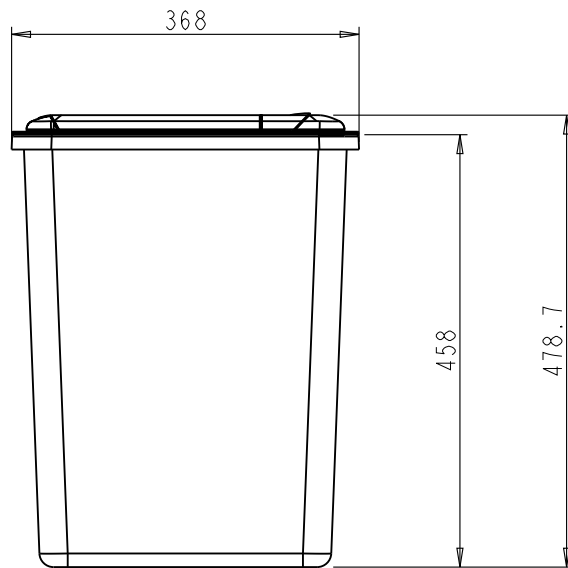

<b>hardware resources</b>  PROPRIETARY AND CONFIDENTIAL  THE INFORMATION CONTAINED IN THIS DRAWING IS THE SOLE PROPERTY OF HARDWARE RESOURCES INC. ANY REPRODUCTION IN PART OR AS A WHOLE WITHOUT THE WRITTEN PERMISSION OF HARDWARE RESOURCES INC. IS PROHIBITED	ITEM#		MATERIAL:	
	TRASH-CAN-35		WEIGHT:	
	FINISH:		9	
			PROJECTION:	
	TOLERANCE UNLESS OTHERWISE SPECIFIED: X : MM ±0.20 X X : MM ±0.10 X X X : MM ±0.05 ANGULAR: ±0.5° DO NOT SCALE DRAWING	UNIT:	DRAWN BY: <i>alan. liu</i>	DATE:
		SIZE:	CHECKED BY:	DATE:
			APPROVED BY:	DATE:

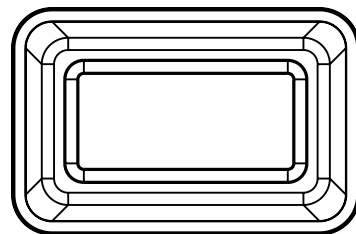
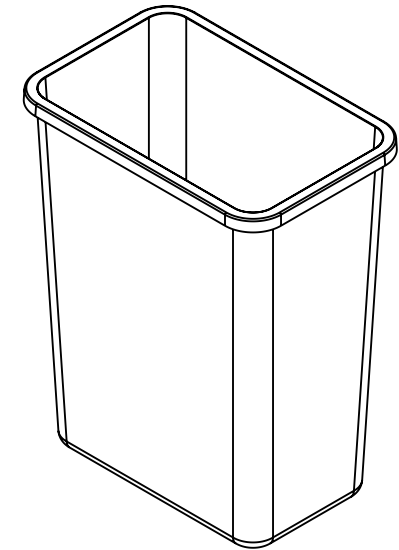
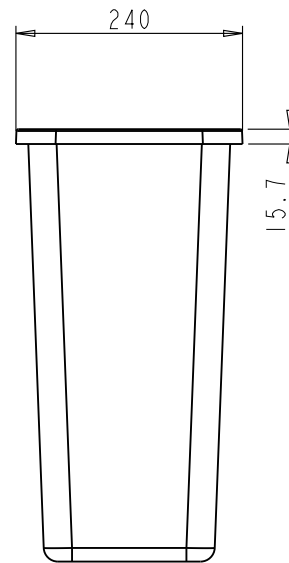
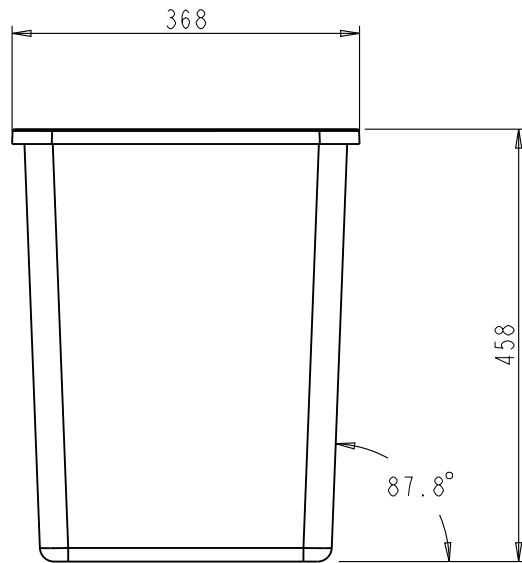

Note:

1. Shell thickness is 2MM

<b>hardware resources</b> PROPRIETARY AND CONFIDENTIAL THE INFORMATION CONTAINED IN THIS DRAWING IS THE SOLE PROPERTY OF HARDWARE RESOURCES INC. ANY REPRODUCTION IN PART OR AS A WHOLE WITHOUT THE WRITTEN PERMISSION OF HARDWARE RESOURCES INC. IS PROHIBITED.	ITEM#: CAN-35		MATERIAL:	
	FINISH:		WEIGHT: 9	
	TOLERANCE UNLESS OTHERWISE SPECIFIED: X : MM ±0.20 X.X : MM ±0.10 X.XX : MM ±0.05 ANGULAR: ±0.5° DO NOT SCALE DRAWING		PROJECTION:	
	UNIT:	DRAWN BY: alan.liu	DATE:	
	SIZE:	CHECKED BY:	DATE:	
		APPROVED BY:	DATE:	

LID-ROTATED-35



LID-FIXED-35



ASSEMBLY STATUS

EXPLODED STATUS

<div>hardware resources</div> <div>PROPRIETARY AND CONFIDENTIAL</div> <div>THE INFORMATION CONTAINED IN THIS DRAWING IS THE SOLE PROPERTY OF HARDWARE RESOURCES INC. ANY REPRODUCTION IN PART OR AS A WHOLE WITHOUT THE WRITTEN PERMISSION OF HARDWARE RESOURCES INC. IS PROHIBITED</div>	ITEM#		MATERIAL:	
	LID-35		WEIGHT:	
	FINISH:		9	
			PROJECTION:	
	TOLERANCE UNLESS OTHERWISE SPECIFIED: X : MM ±0.20 X.X : MM ±0.10 X.XX : MM ±0.05 ANGULAR: ±0.5° DO NOT SCALE DRAWING	UNIT:	DRAWN BY:	DATE:
		SIZE:	CHECKED BY:	DATE:
			APPROVED BY:	DATE:

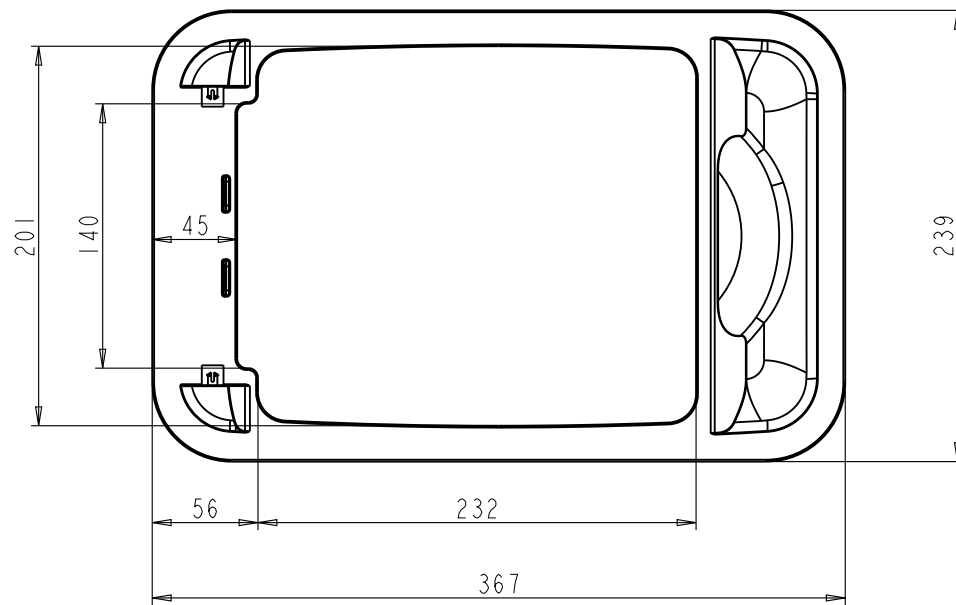

TOP VIEW

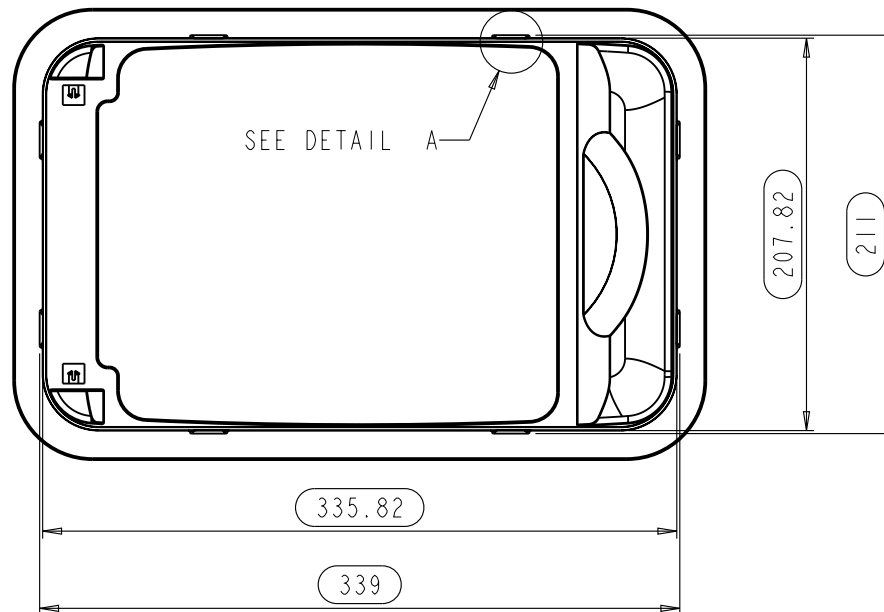

BOTTOM VIEW

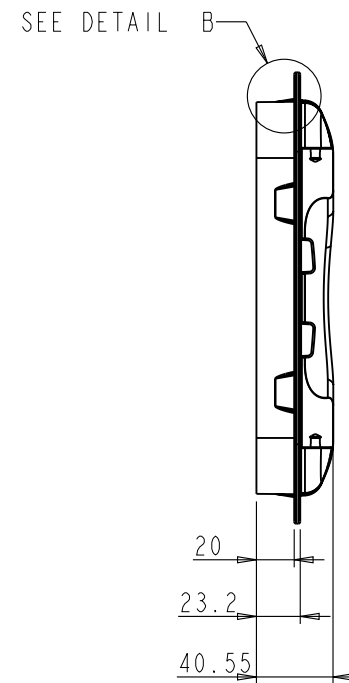

SIDE VIEW

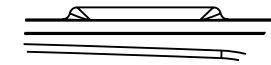

DETAIL A  
SCALE 1:1

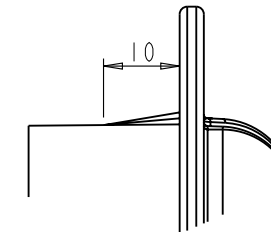

DETAIL B  
SCALE 1:1



<b>hardware resources</b> PROPRIETARY AND CONFIDENTIAL THE INFORMATION CONTAINED IN THIS DRAWING IS THE SOLE PROPERTY OF HARDWARE RESOURCES INC. ANY REPRODUCTION IN PART OR AS A WHOLE WITHOUT THE WRITTEN PERMISSION OF HARDWARE RESOURCES INC. IS PROHIBITED.	ITEM: LID-FIXED-35		MATERIAL: PP	
	FINISH:		WEIGHT: 168.10 g	
	TOLERANCE UNLESS OTHERWISE SPECIFIED: X: MM ±0.20 X.X: MM ±0.10 X.XX: MM ±0.05 ANGULAR: ±0.5° DO NOT SCALE DRAWING		PROJECTION:	
	UNIT: SIZE	DRAWN BY: alan.liu	CHECKED BY:	DATE:
		APPROVED BY:		DATE:

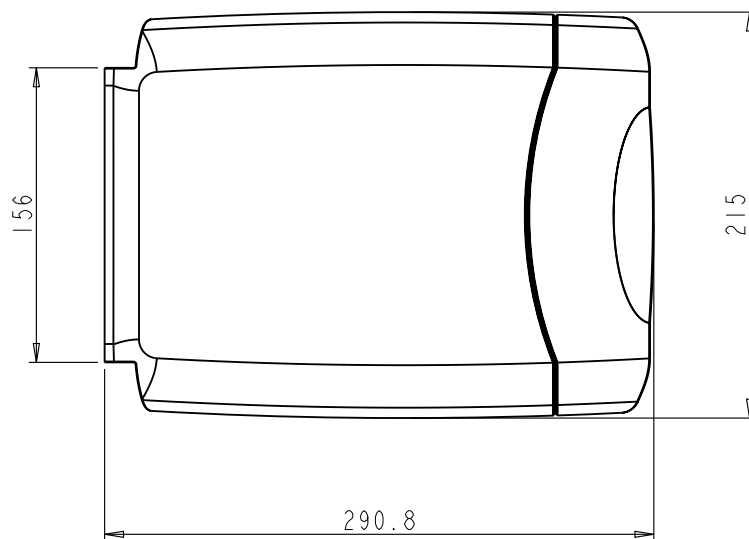

TOP VIEW

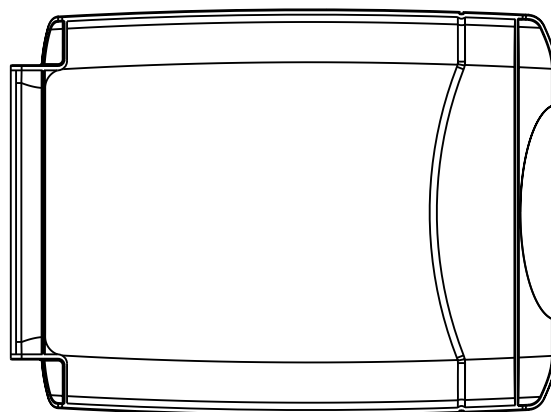

BOTTOM VIEW

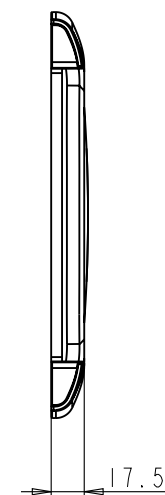

SIDE VIEW



<b>hardware resources</b> PROPRIETARY AND CONFIDENTIAL THE INFORMATION CONTAINED IN THIS DRAWING IS THE SOLE PROPERTY OF HARDWARE RESOURCES INC. ANY REPRODUCTION IN PART OR AS A WHOLE WITHOUT THE WRITTEN PERMISSION OF HARDWARE RESOURCES INC. IS PROHIBITED.	ITEM: LID-ROTATED-35		MATERIAL: PP	
	FINISH:		WEIGHT: 174.00 g	
	TOLERANCE UNLESS OTHERWISE SPECIFIED: X : MM ±0.20 X.X : MM ±0.10 X.XX : MM ±0.05 ANGULAR: ±0.5° DO NOT SCALE DRAWING		PROJECTION:	DATE:
	UNIT:	DRAWN BY: alan.liu	CHECKED BY:	DATE:
	SIZE:	APPROVED BY:		DATE: